

NOTICE!!

These documents have been scanned!

Do not place un-scanned documents beneath this notice!

Do not remove this notice from this file!

GPO Jacket No. 560-102
Print Order 61540
Rise Business Services, LLC
Job=AZ15 4/26/2019



Box Number= AZ15002



Claim Begin-End: AMC449841-AMC449841

1 Initial Receipt



AZ15002-14

AMC450400-AMC453366

United States Department of the Interior
Bureau of Land Management
 DIV OF LANDS, MINRLS & ENERGY
 ONE N CENTRAL AVE
 PHOENIX, AZ 85004 -4427
 Phone: 602-417-9200

Receipt

No: 4110972

Transaction #: 4224106	
Date of Transaction: 03/13/2018	
CUSTOMER:	
	GRE INC 331 S RIO GRANDE ST STE 201 SALT LAKE CITY, UT 84101-1136 US

ENTERED
 MAR 19 2018
 BY: *Rdm*

LINE #	QTY	DESCRIPTION	REMARKS	UNIT PRICE	TOTAL
1	1.00	LOCATABLE MINERALS / MINING CLAIMS-NEW, UNADJUD, ONE OR MORE AUTH NOS / NEW MINING CLAIM PROCESSING FEE CASES: AMC449841/\$20.00		- n/a -	20.00
2	1.00	LOCATABLE MINERALS / MINING CLAIMS-NEW, UNADJUD, ONE OR MORE AUTH NOS / NEW MINING CLAIMS LOCATION FEE CASES: AMC449841/\$37.00		- n/a -	37.00
3	1.00	LOCATABLE MINERALS / MINING CLAIMS-NEW, UNADJUD, ONE OR MORE AUTH NOS / NEW MINING CLAIMS MAINTENANCE FEE CASES: AMC449841/\$155.00		- n/a -	155.00
4	1.00	OVERPAYMENT / OVERPAYMENT OF FEES / OVERPAYMENT OF \$1.00 OR MORE		212.00	212.00
TOTAL:					\$424.00

PAYMENT INFORMATION			
1	AMOUNT:	424.00	POSTMARKED: N/A
	TYPE:	CHECK	RECEIVED: 03/12/2018
	CHECK NO:	003765	
	NAME:	GRE INC 2091 E MURRAY HOLLADAY RD STE 22E SALT LAKE CITY UT 84117 US	

REMARKS

COVER LETTER SAID THERE WERE (2) MINING CLAIMS BUT THE CONTENTS ONLY HAD
(1) - TMC

This receipt was generated by the automated BLM Collections and Billing System and is a paper representation of a portion of the official electronic record contained therein.

NOTICE!!

These documents have been scanned!

Do not place un-scanned documents beneath this notice!

Do not remove this notice from this file!

GPO Jacket No. 560-102
Print Order 61540
Rise Business Services, LLC
Job=AZ15 4/26/2019



Box Number= AZ15002



Claim Begin-End: AMC449841-AMC449841

2 Correspondence



AZ15002-14

AMC450400-AMC453366



United States Department of the Interior



BUREAU OF LAND MANAGEMENT

Arizona State Office

One North Central Avenue, Suite 800

Phoenix, Arizona 85004-4427

www.blm.gov/az/

NOV 05 2018

In Reply Refer To:

3800 (9200) RM

AMC449841, AMC450144

CERTIFIED MAIL - RETURN RECEIPT REQUESTED No. 9214 8901 9403 8374 6980 72

NOTICE

WILLIAM SHIRK
1011 CONDOR DR
GRAND PRAIRIE, TX 75051-3348

:
:
:

This Notice Affects the Claims
Shown in the Block Below.

AMC449841, AMC450144

ABRIL 2, ABRIL 3

Mining Claim Location Notice(s) – Amendment(s) Required

Pursuant to Title 43 Code of Federal Regulations (CFR) 3832.1, the Bureau of Land Management (BLM), Arizona State Office, received your notice(s) of location for recording mining claims. In accordance with 43 CFR 3832.12, the claim(s) listed above cannot be accepted as filed and must be amended as noted below.

- AMC449841 - The tie-in description states corner 1 of the claim is 1,668 feet North 36°55'19" West, from the northeast corner of T. 18 S., R. 23 E., sec. 3. This would place the claim in T. 17 S., R. 23 E., sec. 35 not sec. 34 as described on the location notice. If the tie-in was the northwest corner of T. 18 S., R. 23 E., sec. 3, the claim would be located in T. 17 S., R. 23 E., sec. 34.
- AMC450144 - The tie-in description states corner 1 of the claim is 1,537 feet North 23°58'7" East, from the northeast corner of T. 18 S., R. 23 E., sec. 3. This would place the claim in T. 17 S., R. 23 E., sec. 35 not sec. 34 as described on the location notice. If the tie-in was the northwest corner of T. 18 S., R. 23 E., sec. 3, the claim would be located in T. 17 S., R. 23 E., sec. 34.

An amendment must be filed for each claim listed in the block above to correct the defects identified. There is a \$15 BLM processing fee for each amendment. The amendments must be received by BLM within 30-days of your receipt of this notice. If the amendments are not

received within the 30-day timeframe, the mining claims will be declared null and void.

If additional information is required, please contact RéAnn Myers at 602-417-9413. Please include your AMC serial number(s) on all correspondence.



Lucas Lucero
Deputy State Director
Lands, Minerals and Energy Division

Enclosure(s)



Date Produced: 11/12/2018

ConnectSuite Inc.:

The following is the delivery information for Certified Mail™/RRE item number 9214 8901 9403 8374 6980 72. Our records indicate that this item was delivered on 11/10/2018 at 05:01 p.m. in GRAND PRAIRIE, TX 75051. The scanned image of the recipient information is provided below.

Signature of Recipient :

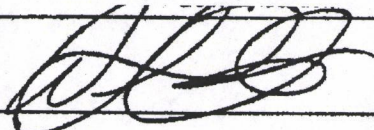
Signature	
X	
Printed Name	

Address of Recipient :

Delivery Address	1011 CONDOR DR
------------------	----------------

Thank you for selecting the Postal Service for your mailing needs. If you require additional assistance, please contact your local post office or Postal Service representative.

Sincerely,
United States Postal Service

The customer reference number shown below is not validated or endorsed by the United States Postal Service. It is solely for customer use.

Customer Reference Number: C1067015.6148197

NOTICE!!

These documents have been scanned!

Do not place un-scanned documents beneath this notice!

Do not remove this notice from this file!

GPO Jacket No. 560-102
Print Order 61540
Rise Business Services, LLC
Job=AZ15 4/26/2019



Box Number= AZ15002



Claim Begin-End: AMC449841-AMC449841

3 Transfers



AZ15002-14

AMC450400-AMC453366



449 123

449 841

450 144

When Recorded Mail To:
GRE Inc
331 S. Rio Grande Street
Suite #201
SLC, UT 84101

RECEIVED
BLM AZ STATE OFFICE
2018 AUG 21 P 2:02
PHOENIX, ARIZONA

Quit Claim Deed

Quit Claim Deed Exempt Per ARS 11-1134 A6

THE GRANTOR(S): GRE, Inc., of the City of Salt Lake, County of Salt Lake, State of Utah 84101

For and in consideration of monetary compensation or trade, do CONVEY and QUIT CLAIM to:

THE GRANTEE(S):

- William Shirk of 1011 Condor Drive, in the city Grand Prairie, county of Dallas, state of TX 75051,

In the form of Sole Ownership, all interest in the following described Mining Claim Property(s) situated in the County of Cochise, in the State of Arizona, to wit:

- ✓ Abril, AMC #449123 Located in Section 34, Township 17S, Range 23E
- ✓ Abril 2, AMC#449841 Located in Section 34, Township 17S Range 23E
- ✓ Abril 3, AMC#450144 Located in Section 34, Township 17S Range 23E

Hereby releasing and waiving all rights under and by virtue of the Mining and Location laws of the State of Arizona.

Dated this 14th day of August, 2018

Signature(s) of Grantor(s):

JESSICA SHUMAN GRE, Inc. Representative

Name & Address of Preparer: JESSICA SHUMAN, an Agent for GRE, Inc. -
331 S. Rio Grande Street, Suite #201, SLC, UT 84101

SIGNED
Signature of Claim owner's agent JESSICA SHUMAN

BY JESSICA SHUMAN
Printed name of Claim owner's agent
STATE OF UTAH
COUNTY OF SALT LAKE

On the _____ day of _____, 2018, JESSICA SHUMAN did personally appear before me, the Undersigned notary public in and for the County of Salt Lake, in said State of Utah, Who acknowledged to me that he/she signed it freely and voluntarily for the purposes therein mentioned.

Notary Public of Salt Lake County, Utah

My commission expires on _____

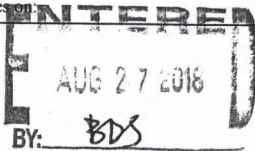
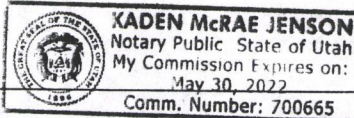

#4241586

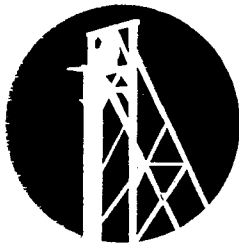

GOLD RUSH
EXPEDITIONS

8/15/2018

GRE, Inc.
331 S. Rio Grande Street
Suite #201
SLC, UT 84101

Arizona BLM

Re: 1 Quit Claim Deed

RECEIVED
BLM ARIZONA OFFICE
2018 AUG 21 P 2:02
PHOENIX, ARIZONA

Dear Arizona BLM Cashier,

Please find enclosed 1 Quit Claim Deed (s) for filing. I understand there is a fee for recording this documents. Please find a check addressed to the BLM for these fees. Please send the recorded documents back to GRE, Inc.

Thank you for your time and efforts.

Sincerely,

GRE Accounting
385-218-2138
accounting@goldrushexpeditions.com
www.goldrushexpeditions.com

2091 E Murray Holladay Rd. Ste. 22E, Salt Lake City, UT, 84117

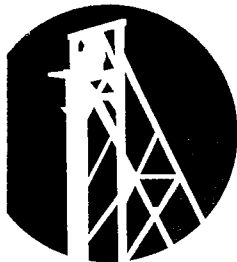

GOLD RUSH

EXPEDITIONS

GRE Inc

331 S. Rio Grande Street

Suite #201

SLC, UT 84101



7018 0680 0001 1809 7549



\$4.75E US POSTAGE
FIRST CLASS
PERMIT NO. 100
PHOENIX, AZ

RECEIVED
BLM STATE OFFICE
2018 AUG 21 P 2:02
PHOENIX, ARIZONA

Arizona BLM
Attn: Cashier
One N. Central Ave., Ste. 800
Phoenix, AZ 85004



United States Department of the Interior
Bureau of Land Management
 DIV OF LANDS, MINRLS & ENERGY
 ONE N CENTRAL AVE
 PHOENIX, AZ 85004 -4427
 Phone: 602-417-9200

Receipt

No: 4241586

Transaction #: 4357001	
Date of Transaction: 08/22/2018	
CUSTOMER:	
GRE INC 331 S RIO GRANDE ST STE 201 SALT LAKE CITY,UT 84101-1136 US	

LINE #	QTY	DESCRIPTION	REMARKS	UNIT PRICE	TOTAL
1	1.00	LOCATABLE MINERALS / MINING CLAIMS- NOT NEW-UNADJUD,ONE AUTH NO. ONLY / MINING CLAIM MONEY RECEIVED CASES: AMC449123/\$30.00	TRF/3	- n/a -	30.00
TOTAL:					\$30.00

PAYMENT INFORMATION			
1	AMOUNT:	30.00	POSTMARKED: N/A
	TYPE:	CHECK	RECEIVED: 08/21/2018
	CHECK NO:	004440	
	NAME:	GRE INC 2091 E MURRAY HOLLADAY RD STE 22E SALT LAKE CITY UT 84117 US	

REMARKS

This receipt was generated by the automated BLM Collections and Billing System and is a paper representation of a portion of the official electronic record contained therein.

NOTICE!!

These documents have been scanned!

Do not place un-scanned documents beneath this notice!

Do not remove this notice from this file!

GPO Jacket No. 560-102
Print Order 61540
Rise Business Services, LLC
Job=AZ15 4/26/2019



Box Number= AZ15002



Claim Begin-End: AMC449841-AMC449841

4 Annual Filings



AZ15002-14 AMC450400-AMC453366

DEPARTMENT OF THE INTERIOR
BUREAU OF LAND MANAGEMENT
MINING CLAIMS

Run Date/Time: 8/20/2018

MC Maintenance Fees Paid Through the BLM Pay Portal
(by Date Paid)

Page 202 Of 316

CBS Receipt: 4235418

Printed For Lead File # AMC449841

Agency Tracking ID: 1534267551

Assessment Year: 2019

Paid On: 8/14/2018

Number of BLM Serial Nr: 3

Total Amount Paid: \$465.00

Claim Name	BLM Serial No	Lead File No	Amount Paid
ABRIL	AMC449123	AMC449123	\$155.00
ABRIL 2	AMC449841	AMC449841	\$155.00
ABRIL 3	AMC450144	AMC450144	\$155.00

United States Department of the Interior

Bureau of Land Management

BUSINESS & SUPPORT SVCS DIV

ONE N CENTRAL AVE SUITE 800

PHOENIX, AZ 85004 -4427

Phone: 602-417-9200

Receipt

No:

4235418

Transaction #: 4350779	
Date of Transaction: 08/14/2018	
CUSTOMER:	
WILLIAM E SHIRK 1011 CONDOR DR GRAND PRAIRIE, TX 75051 US	

LINE #	QTY	DESCRIPTION	REMARKS	UNIT PRICE	TOTAL
1	1.00	LOCATABLE MINERALS / MINING CLAIMS- NOT NEW-UNADJUD, ONE AUTH NO. ONLY / MINING CLAIM MONEY RECEIVED CASES: AMC449123/\$465.00		- n/a -	465.00
TOTAL:					\$465.00

PAYMENT INFORMATION				
NOTE: Items will appear on credit card statement as "BLM O Mining Claim".				
1	AMOUNT:	465.00	POSTMARKED:	N/A
	TYPE:	CREDIT CARD	RECEIVED:	08/14/2018
	NAME:	WILLIAM E SHIRK 1011 CONDOR DR GRAND PRAIRIE TX 75051 US		
	CARD NO:	XXXXXXXXXXXX3166	AUTH CODE:	05046B
	NAME ON CARD:	WILLIAM E SHIRK		
	SIGNATURE:			

REMARKS

This receipt was generated by the automated BLM Collections and Billing System and is a paper representation of a portion of the official electronic record contained therein.

NOTICE!!

These documents have been scanned!

Do not place un-scanned documents beneath this notice!

Do not remove this notice from this file!

GPO Jacket No. 560-102
Print Order 61540
Rise Business Services, LLC
Job=AZ15 4/26/2019



Box Number= AZ15002



Claim Begin-End: AMC449841-AMC449841

5 Miscellaneous



AZ15002-14

AMC450400-AMC453366

Amc 449841

450144

12/3/2018

GRE, Inc.
331 S. Rio Grande Street
Suite #201
SLC, UT 84101

Arizona BLM

Re: 2 Amended Notice of Locations

Dear Arizona BLM Cashier,

Please find enclosed 2 Amended Notice of Locations (s) for filing. I understand there is a fee for recording this documents. Please find a check addressed to the BLM for these fees. Please send the recorded documents back to GRE, Inc.

Thank you for your time and efforts.

Sincerely,

GRE Accounting
385-218-2138
accounting@goldrushexpeditions.com
www.goldrushexpeditions.com

PHOENIX, ARIZONA

2018 DEC 10 P 2:50

RECEIVED
BLM AZ STATE OFFICE

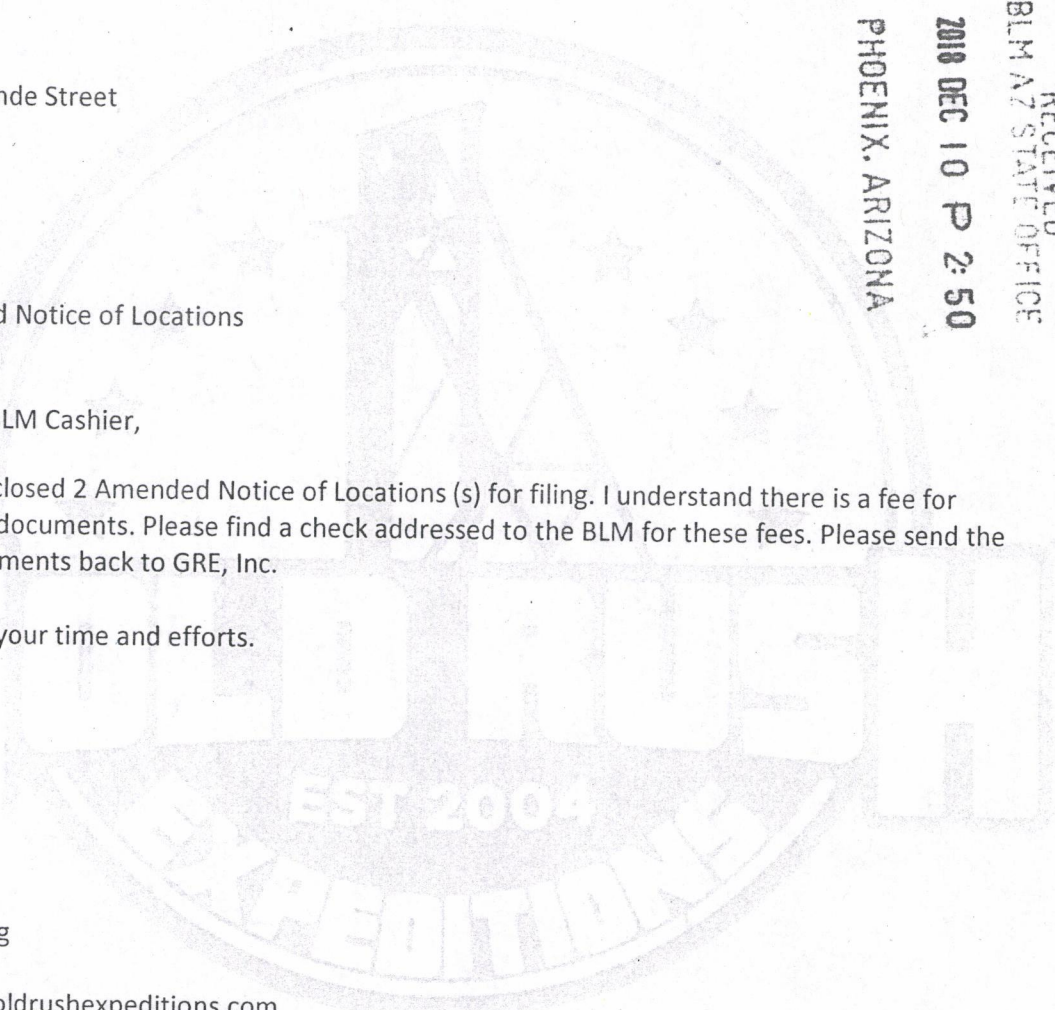

GRE Inc
331 S. R
SLC, UT 84101

CERTIFIED MAIL



7018 0480 0001 1811 7926



Arizona BLM
Attn: Cashier
One N. Central Ave., Ste. 800
Phoenix, AZ 85004

RECEIVED
BY MAIL SERVICE
2018 DEC 10 P 2:50
PHOENIX, ARIZONA

United States Department of the Interior
Bureau of Land Management
 DIV OF LANDS, MINRLS & ENERGY
 ONE N CENTRAL AVE
 PHOENIX, AZ 85004 -4427
 Phone: 602-417-9200

Receipt

No: 4331522

Transaction #: 4448187	
Date of Transaction: 12/11/2018	
CUSTOMER:	
GRE INC 331 S RIO GRANDE ST STE 201 SALT LAKE CITY, UT 84101-1136 US	

LINE #	QTY	DESCRIPTION	REMARKS	UNIT PRICE	TOTAL
1	1.00	LOCATABLE MINERALS / MINING CLAIMS- NOT NEW-UNADJUD, ONE AUTH NO. ONLY / MINING CLAIM MONEY RECEIVED CASES: AMC449841/\$30.00	AMEND/2	- n/a -	30.00
TOTAL:					\$30.00

PAYMENT INFORMATION			
1	AMOUNT:	30.00	POSTMARKED: N/A
	TYPE:	CHECK	RECEIVED: 12/10/2018
	CHECK NO:	004641	
	NAME:	GRE INC 331 S RIO GRANDE ST STE 201 SALT LAKE CITY UT 84101-1136 US	

REMARKS

This receipt was generated by the automated BLM Collections and Billing System and is a paper representation of a portion of the official electronic record contained therein.

*FOR AMENDMENTS ON
 AMC 449841 AND AMC 450144.
 635 ENTERED 2/6/2019. RM*

Authorized Date10/11/2018

Instructions to Accounts AZ BLM REFUND \$212, TO GRE INC; FOR OVERPAYMENT OF FEES,
ON AMC449841, RECEIPT #4110972. RM

Login ID6222

Entry Date10/11/2018

Total Amount\$212.00

R

United States Department of the Interior
Bureau of Land Management
 DIV OF LANDS, MINRLS & ENERGY
 ONE N CENTRAL AVE
 PHOENIX, AZ 85004 -4427
 Phone: 602-417-9200

Receipt

No: 4110972

Transaction #: 4224106	
Date of Transaction: 03/13/2018	
CUSTOMER:	
	GRE INC 331 S RIO GRANDE ST STE 201 SALT LAKE CITY, UT 84101-1136 US

LINE #	QTY	DESCRIPTION	REMARKS	UNIT PRICE	TOTAL
1	1.00	LOCATABLE MINERALS / MINING CLAIMS-NEW, UNADJUD, ONE OR MORE AUTH NOS / NEW MINING CLAIM PROCESSING FEE CASES: AMC449841/\$20.00		- n/a -	20.00
2	1.00	LOCATABLE MINERALS / MINING CLAIMS-NEW, UNADJUD, ONE OR MORE AUTH NOS / NEW MINING CLAIMS LOCATION FEE CASES: AMC449841/\$37.00		- n/a -	37.00
3	1.00	LOCATABLE MINERALS / MINING CLAIMS-NEW, UNADJUD, ONE OR MORE AUTH NOS / NEW MINING CLAIMS MAINTENANCE FEE CASES: AMC449841/\$155.00		- n/a -	155.00
4	1.00	OVERPAYMENT / OVERPAYMENT OF FEES / OVERPAYMENT OF \$1.00 OR MORE		212.00	212.00
TOTAL:					\$424.00

REFUND PROCESSED 10/11/2018. 379 ENTERED. ERM

PAYMENT INFORMATION			
1	AMOUNT:	424.00	POSTMARKED: N/A
	TYPE:	CHECK	RECEIVED: 03/12/2018
	CHECK NO:	003765	
	NAME:	GRE INC 2091 E MURRAY HOLLADAY RD STE 22E SALT LAKE CITY UT 84117 US	

REMARKS

COVER LETTER SAID THERE WERE (2) MINING CLAIMS BUT THE CONTENTS ONLY HAD
(1) - TMC

This receipt was generated by the automated BLM Collections and Billing System and is a paper representation of a portion of the official electronic record contained therein.

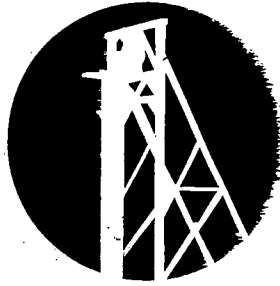

GOLD RUSH
EXPEDITIONS

3/8/2018

GRE, Inc.
331 S. Rio Grande Street
Suite #201
SLC, UT 84101

Arizona BLM

Re: 2 Notice of Locations

Dear Arizona BLM Cashier,

Please find enclosed two notice of locations (s) for filing. I understand there is a fee for recording this document. I have enclosed a check for the fees. Please send the recorded documents with a receipt back to GRE, Inc.

Thank you for your time and efforts.

Sincerely,

GRE Accounting
385-218-2138
accounting@goldrushexpeditions.com
www.goldrushexpeditions.com

goldrush@

RECEIVED
2018 MAR 12 P 2:30
PHOENIX, ARIZONA

NOTICE!!

These documents have been scanned!

Do not place un-scanned documents beneath this notice!

Do not remove this notice from this file!

GPO Jacket No. 560-102
Print Order 61540
Rise Business Services, LLC
Job=AZ15 4/26/2019



Box Number= AZ15002



Claim Begin-End: AMC449841-AMC449841

6 Location Notices-Amendments and Supporting Documents



AZ15002-14

AMC450400-AMC453366

MINING CLAIM STATUS REPORT

Data Entered: 3/19/18 Ram

MTP Checked By: 3/19/18 Ram

GEO Checked By: 3/19/18 Ram

LEAD SERIAL NUMBER: AMC 449841 thru AMC _____

NUMBER OF CLAIMS & TYPE:

1 LODE
____ PLACER
____ ASSOCIATION PLACER
____ MILL SITE
____ TUNNEL SITE

CHARGES:

Processing Fee @ \$20 = \$ 20
Location Fee @ \$37 = \$ 37
Maintenance Fee @ \$155 = \$ 155
Add'l Maint Fee for Assoc Placer = \$ _____
SUBTOTAL \$ _____
over pymnt Other Fees \$ 212
Other Fees \$ _____
TOTAL \$ 424

TOTAL ACREAGE: _____ Per Claim
(Placer Only)

NUMBER OF LOCATORS: _____

DOCUMENTS RECEIVED VIA: Over-the-Counter [] Mail **TIMELY FILED:** Yes No []

LEGAL DESCRIPTION: T 175 R 23E SEC 34
T _____ R _____ SEC _____
T _____ R _____ SEC _____
T _____ R _____ SEC _____
T _____ R _____ SEC _____

BLM [] FOREST SERVICE [] _____ SUBJ TO PL 359: Yes [] No []
WILDERNESS AREA [] _____

SPLIT ESTATE: N/A [] SX [] PX [] OTHER [] _____
SRHA [] Was proper Notice filed if located on SHRA Land? Yes [] No []

RECONVEYED MINERALS ON BLM LAND REQUIRE OPENING ORDER FROM 1944 TO 1993:
Open to Entry On _____ N/A []

COMMENTS/STATUS: VOID [] PARTIALLY VOID [] PVT MINERALS [] WITHDRAWN LANDS []
OTHER [] _____

AMC449841

[] Claimant acknowledges that portions of the following claim(s) site(s) may be void or voidable.
* cover letter said there are 2 claims - but contents of envelope only had 1. - JMC

Printed Name of Claimant _____ Signature of Claimant _____

*****FINAL ADJUDICATION*****

DATE 10/3/2018 INITIALS JMC

Amended LOCATION NOTICE FOR LODE MINING CLAIM

NOTICE IS HEREBY GIVEN that the ABRIL 2 (AMC449841)

lode mining claim has been located by

GRE INC whose current mailing

address is 331 S RIO GRANDE STREET ST#201, SLC UT 84101

The general course of this claim is NW TO SE and it is

situated in COCHISE County, Arizona. This claim is 1500 feet in length and 600 feet in width.

The ABRIL 2 Lode Mining Claim is located pursuant to 43 C.F.R. 3832.12 (b), and described by metes and bounds, including a description of the tie to an official survey monument as follows:

Beginning at NORTH corner #1, thence 600 feet southwest at 225° to WEST corner #2, thence 1500 feet SOUTHEAST at 135° to SOUTH corner #3, thence 600 feet northeast at 45°, to EAST corner #4, thence 1500 feet NORTHWEST at 315° back to NORTH corner #1, place of beginning.

Tie Point: Beginning at T 18S R 23E survey monument for the NW corner of section 3, thence North 36° 55 minutes 19 seconds WEST a distance of 1,668 feet to claim corner #1.

The location monument on which this notice is posted is situated within Section 34, Township 17S, Range 23E, Gila Salt River Base and Meridian, Arizona and this claim encompasses portions

of the following quarter section (s), section (s), Township (s) and Range (s) SW ¼ OF SECTION 34 T17S R23E Gila and Salt River Meridian, Arizona.

This Notice of Location has been written to capture mineral rights within its boundaries, only on open and locatable ground. In the case that some or parts of the claim boundaries overlap private or patented land it is understood that no rights or ownership is implied or assumed in relation to that portion of the claim. In the case that any part of this claim boundary may overlap another, pre-existing claim, it is understood that no rights or ownership is implied or assumed in relation to that portion of the claim. Any overlap or overstaking that has occurred is solely due to standard sizing of claims and there is no claim or ownership implied or assumed.

DATED AND POSTED on the ground this 26th day of December, 2017.

LOCATOR (s) _____

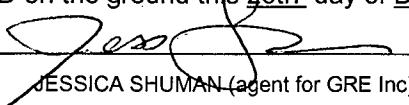
JESSICA SHUMAN (agent for GRE Inc)

RECEIVED
BLM AZ STATE OFFICE
2018 DEC 10 P 2:50
PHOENIX, ARIZONA
BLM
Date
Stamp

AMC 449841

A331522

LOCATION NOTICE FOR LODE MINING CLAIM

NOTICE IS HEREBY GIVEN that the ABRIL 2

lode mining claim has been located by

GRE INC whose current mailing

address is 331 S RIO GRANDE STREET ST#201, SLC UT 84101

The general course of this claim is NW TO SE and it is

situated in COCHISE County, Arizona. This claim is 1500 feet in length and 600 feet in width.

The ABRIL 2 Lode Mining Claim is located pursuant to 43 C.F.R. 3832.12 (b), and described by metes and bounds, including a description of the tie to an official survey monument as follows:

Beginning at NORTH corner #1, thence 600 feet southwest at 225° to WEST corner #2, thence 1500 feet SOUTHEAST at 135° to SOUTH corner #3, thence 600 feet northeast at 45°, to EAST corner #4, thence 1500 feet NORTHWEST at 315° back to NORTH corner #1, place of beginning.

Tie Point: Beginning at T 18S R 23E survey monument for the NE corner of section 3, thence North 36° 55 minutes 19 seconds WEST a distance of 1,668 feet to claim corner #1.

The location monument on which this notice is posted is situated within Section 34, Township 17S, Range 23E, Gila Salt River Base and Meridian, Arizona and this claim encompasses portions

of the following quarter section (s), section (s), Township (s) and Range (s) SW ¼ OF SECTION 34 T17S R23E Gila and Salt River Meridian, Arizona.

This Notice of Location has been written to capture mineral rights within its boundaries, only on open and locatable ground. In the case that some or parts of the claim boundaries overlap private or patented land it is understood that no rights or ownership is implied or assumed in relation to that portion of the claim. In the case that any part of this claim boundary may overlap another, pre-existing claim, it is understood that no rights or ownership is implied or assumed in relation to that portion of the claim. Any overlap or overstaking that has occurred is solely due to standard sizing of claims and there is no claim or ownership implied or assumed.

DATED AND POSTED on the ground this 26th day of December, 2017.

LOCATOR (s) _____

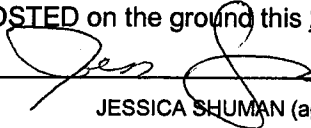

JESSICA SHUMAN (agent for GRE Inc)

BLM Date Stamp	RECEIVED 2018 MAR 12 P 2:30 PHOENIX, ARIZONA
----------------------	--

AHC449841

MINING CLAIM MAP

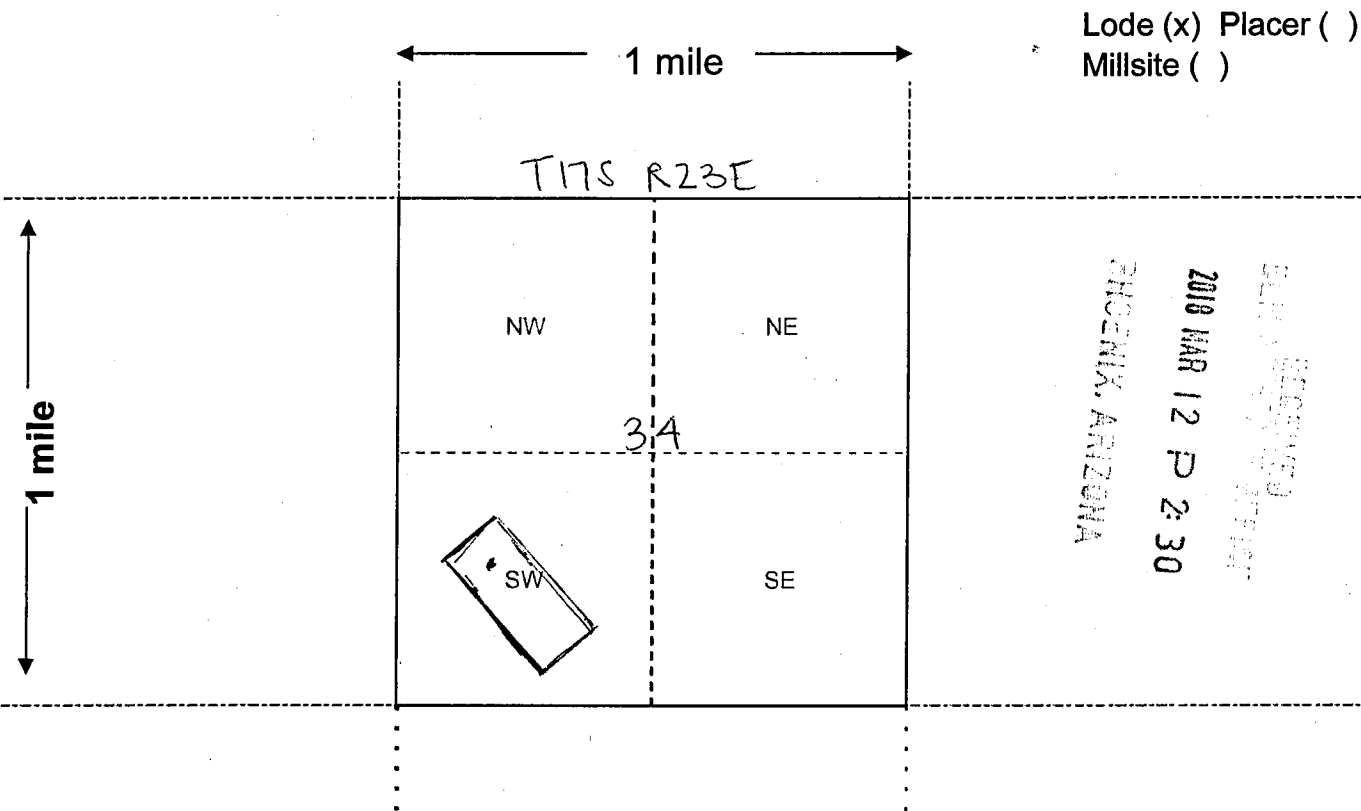

Lode (x) Placer ()
Millsite ()

RECEIVED
2018 MAR 12 P 2:30
PHOENIX, ARIZONA

Scale: 1" = 2000 feet



1. The above map depicts the April 2 Lode mining claim, which is located in Section 34 Township 17S, Range 23E, Gila & Salt River Base Meridian, Cochise County, Arizona (STATE). Total claim acreage is 20.66

2. The type of corner and location monuments used are as follows: 2"X2" WOODEN STAKES
WITH FLAGGING

3. The bearings and distances in degrees and feet between claim corners and to a public land survey monument are as depicted on the map.

4. If the claim is a placer or millsite claim with exterior limits conforming to legal subdivisions of the public survey, provide a legal description of the claim _____

AMC449841

DEPARTMENT OF INTERIOR
BUREAU OF LAND MANAGEMENT

Input Parameters for Geographic Report with Land

System Id = CR

Admin State = AZ

Geo State =

Casetype Begins With

Case Disp Txt = AUTHORIZED, CANCELLED, EXPIRED, PENDING, REJECTED, VOID, WITHDRAWN

Mer Twp Rng =

Section =

Mtrs = 14 0170S 0230E 034, 14 0170S 0230E 999

Commodity =

Commodity Txt =

Pending Org =

Pend Org Decode =

Total Rows Returned: 0

RUN TIME: 10:43 AM

**UNITED STATES DEPARTMENT OF INTERIOR
BUREAU OF LAND MANAGEMENT
GEOGRAPHIC REPORT WITH LAND
Sorted by Serial Number**

**RUN DATE: 03/19/2018
Page 1 of 1**

Adm State:



GOLD RUSH EXPEDITIONS

GRE Inc
331 S. Rio Grande Street
Suite #201
SLC, UT 84101



4-9-11 7-16
FIRST CLASS
062900931348
FROM 84117

Salt Lake UT 841
THU 08 MAR 2018 PM

Arizona BLM
Attn: Cashier
One N. Central Ave., Ste. 800
Phoenix, AZ 85004

RECEIVED
BLM PHOENIX OFFICE
2018 MAR 12 P 2:30
PHOENIX, ARIZONA

